



## FEATURES

- ◆ Wide (2:1) Input Range
- ◆ 24Pin DIP Package
- ◆ 1500VDC Isolation
- ◆ Operating Temperature: -40℃ ~ +85℃
- ◆ High Efficiency Up To 83%
- ◆ Low Profile Metal Package
- ◆ Continuous Short Circuit Protection
- ◆ Pin-Compatible With Multiple Manufacturers
- ◆ RoHS Compliance
- ◆ MTBF>1000Hours

## MODEL SELECTION

**WRB<sup>®</sup>24<sup>®</sup>15<sup>®</sup>Y<sup>®</sup>D<sup>®</sup>-4W(267)<sup>®</sup>**

- ① Product Series      ② Input Voltage
- ③ Output Voltage      ④ Wide (2:1) Input Range
- ⑤ DIP24 Package Style
- ⑥ Rated Power(Output current)

## APPLICATIONS

The WRA\_YD-4W & WRB\_YD-4W Series are specially designed for applications where a wide range input voltage power supplies are isolated from the input power supply in a distributed power supply system on a circuit board. These products apply to:

- 1) Where the voltage of the input power supply is wide range (Voltage ranges 2:1);
- 2) Where isolation is necessary between input and output (Isolation voltage ≤ 1500VDC);
- 3) Where the regulation of the Output voltage and the output ripple noise are demanded.



**CE REACH**  
MICRODC reserves the copyright

## SELECTION GUIDE

Order code	Input		Output	
	Voltage(VDC)		Voltage	Current max.
	Nominal	Range		
WRB1203YD-1000	12	9VDC - 18VDC	3.3VDC	1000mA
WRB1205YD-4W	12	9VDC - 18VDC	5VDC	800mA
WRB1207YD-4W	12	9VDC - 18VDC	7.2VDC	556mA
WRB1209YD-4W	12	9VDC - 18VDC	9VDC	444mA
WRB1212YD-4W	12	9VDC - 18VDC	12VDC	333mA
WRB1215YD-4W	12	9VDC - 18VDC	15VDC	267mA
WRB1218YD-4W	12	9VDC - 18VDC	18VDC	222mA
WRB1224YD-4W	12	9VDC - 18VDC	24VDC	167mA
WRB2403YD-1000	24	18VDC - 36VDC	3.3VDC	1000mA
WRB2405YD-4W	24	18VDC - 36VDC	5VDC	800mA
WRB2407YD-4W	24	18VDC - 36VDC	7.2VDC	556mA
WRB2409YD-4W	24	18VDC - 36VDC	9VDC	444mA
WRB2412YD-4W	24	18VDC - 36VDC	12VDC	333mA
WRB2415YD-4W	24	18VDC - 36VDC	15VDC	267mA
WRB2418YD-4W	24	18VDC - 36VDC	18VDC	222mA
WRB2424YD-4W	24	18VDC - 36VDC	24VDC	167mA
WRB4803YD-1000	48	36VDC - 72VDC	3.3VDC	1000mA
WRB4805YD-4W	48	36VDC - 72VDC	5VDC	800mA
WRB4807YD-4W	48	36VDC - 72VDC	7.2VDC	556mA
WRB4809YD-4W	48	36VDC - 72VDC	9VDC	444mA
WRB4812YD-4W	48	36VDC - 72VDC	12VDC	333mA
WRB4815YD-4W	48	36VDC - 72VDC	15VDC	267mA
WRB4818YD-4W	48	36VDC - 72VDC	18VDC	222mA
WRB4824YD-4W	48	36VDC - 72VDC	24VDC	167mA
WRA1203YD-500	12	9VDC - 18VDC	±3.3VDC	±500mA
WRA1205YD-4W	12	9VDC - 18VDC	±5VDC	±400mA
WRA1207YD-4W	12	9VDC - 18VDC	±7.2VDC	±278mA
WRA1209YD-4W	12	9VDC - 18VDC	±9VDC	±222mA
WRA1212YD-4W	12	9VDC - 18VDC	±12VDC	±167mA
WRA1215YD-4W	12	9VDC - 18VDC	±15VDC	±133mA
WRA1218YD-4W	12	9VDC - 18VDC	±18VDC	±111mA
WRA1224YD-4W	12	9VDC - 18VDC	±24VDC	±83mA
WRA2403YD-500	24	18VDC - 36VDC	±3.3VDC	±500mA
WRA2405YD-4W	24	18VDC - 36VDC	±5VDC	±400mA
WRA2407YD-4W	24	18VDC - 36VDC	±7.2VDC	±278mA
WRA2409YD-4W	24	18VDC - 36VDC	±9VDC	±222mA
WRA2412YD-4W	24	18VDC - 36VDC	±12VDC	±167mA
WRA2415YD-4W	24	18VDC - 36VDC	±15VDC	±133mA
WRA2418YD-4W	24	18VDC - 36VDC	±18VDC	±111mA
WRA2424YD-4W	24	18VDC - 36VDC	±24VDC	±83mA
WRA4803YD-500	48	36VDC - 72VDC	±3.3VDC	±500mA
WRA4805YD-4W	48	36VDC - 72VDC	±5VDC	±400mA
WRA4807YD-4W	48	36VDC - 72VDC	±7.2VDC	±278mA
WRA4809YD-4W	48	36VDC - 72VDC	±9VDC	±222mA
WRA4812YD-4W	48	36VDC - 72VDC	±12VDC	±167mA
WRA4815YD-4W	48	36VDC - 72VDC	±15VDC	±133mA
WRA4818YD-4W	48	36VDC - 72VDC	±18VDC	±111mA
WRA4824YD-4W	48	36VDC - 72VDC	±24VDC	±83mA



### OUTLINE DIMENSIONS & FOOTPRINT DETAILS

#### MECHANICAL DIMENSIONS

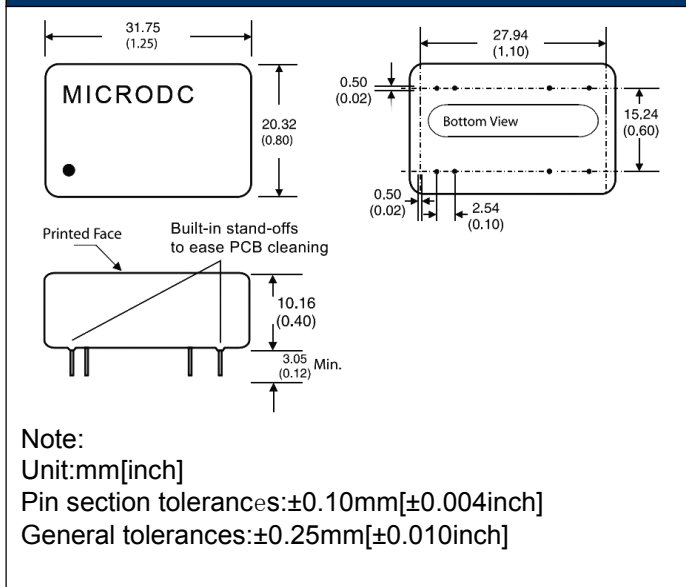

#### RECOMMENDED FOOTPRINT

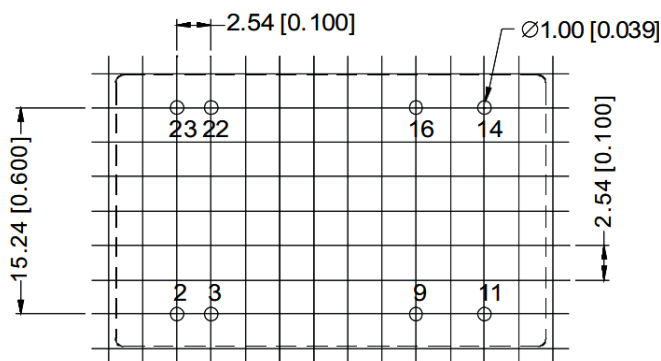

RECOMMENDED FOOTPRINT  
 Top view grid:2.54mm(0.1inch)  
 diameter:1.00mm(0.039inch)

#### FOOTPRINT DETAILS

Pin	Single	Dual
2、3	-V Input	-V Input
9	N.C	Common
11	N.C	-V Output
14	+V Output	+V Output
16	-V Output	Common
22、23	+V Input	+V Input

NC:No connection

**When the environment temperature is higher than 71°C, the product output power should be less than 60% of the rated power.**  
**No parallel connection or plug and play.**  
**Use dual output simultaneously,forbid pening output pin (0V) to use as single output.**

Note:

- The load shouldn't be less than 10%, otherwise ripple will increase dramatically.
- Operation under 10% load will not damage the converter; However, they may not meet all specification listed.
- All specifications measured at Ta=25°C, humidity<75%, nominal input voltage and rated output load unless otherwise specified.
- In this data sheet, all the test methods of indications are based on corporate standards.
- Only typical models listed, other models may be different, please contact our technical person for more details.

#### TUBE OUTLINE DIMENSIONS

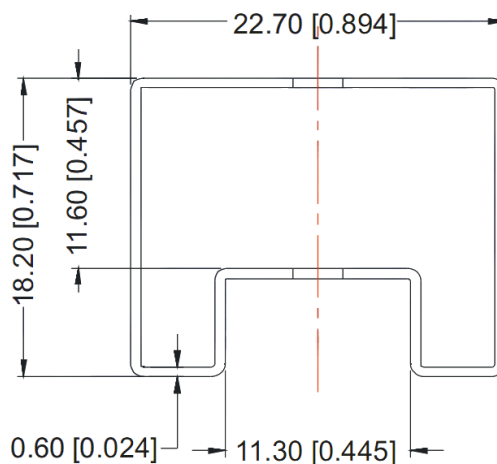

Note:

Unit :mm[inch]

General tolerances:±0.50mm[±0.020inch]

L=530mm[20.866inch] Tube Quantity: 15pcs

L=220mm[8.661inch] Tube Quantity: 6pcs